

# INSTALLATION INSTRUCTIONS

For standard compression gas struts we advise the use of ball joints to alleviate possible side loading, and uneven wearing of the piston rod/seals.

Fit the piston rod down within 60° to the vertical and avoid the strut travelling through a large arc. Install with the rod down for optimum lubrication of the guide and sealing system at all times (see figure 1).

It is advisable to keep the strut in a single plane of movement. Failure to adhere to this advice may result in a reduced lifespan of the strut.

Ensure that the end fittings are tightly fastened onto the thread of the gas struts prior to fitting. If the end fittings require aligning, the piston rod of the gas strut can rotate inside the body (cylinder). Place and hold the piston end fixing on a flat surface, grip the cylinder and firmly twist it until the end fitting is aligned correctly (see figure 2).

fig.1

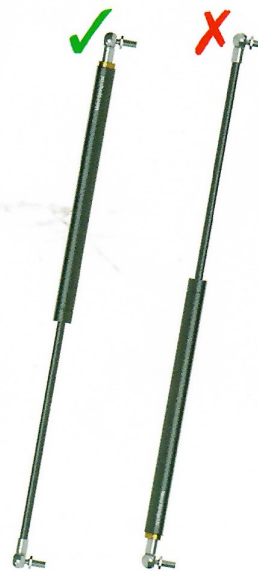
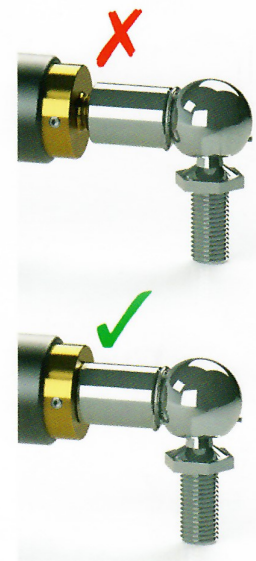

fig.2



## Fitting brackets

When utilising a bracket with a ball stud/end, the procedure to fit it to the relevant ball joint fitting is as follows:

1. Remove the retaining clip from the ball socket by rotating it from around the collar of the socket, and then pull it out from the two locating holes.
2. Ensure the ball socket is fully tightened onto the thread of the strut. Then, using a vice or pair of pliers, grip the ball stud and with a rotating motion, remove the ball stud from the socket.
3. Once removed, place the ball socket over the corresponding bracket and press firmly downwards until a positive 'click' is heard.
4. Once the ball of the bracket is firmly located inside the socket, reinsert the retaining clip into the two locating holes, and clip it back over the collar of the socket.

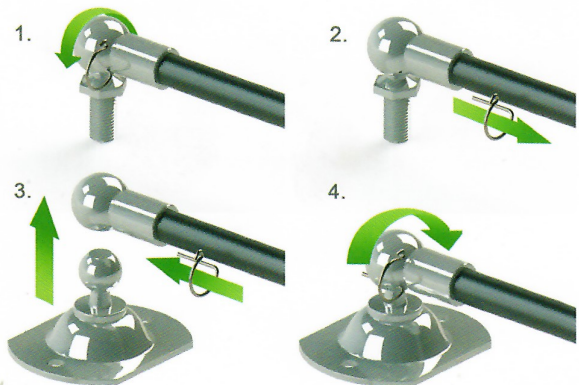

Please ensure you follow these fitting instructions

We cannot be held responsible for any damage to a gas strut if the installation instructions are not adhered to.